

# TOWNSHIP OF GREATER MADAWASKA ZONING BY-LAW SCHEDULE "E"

**Inset # 10**

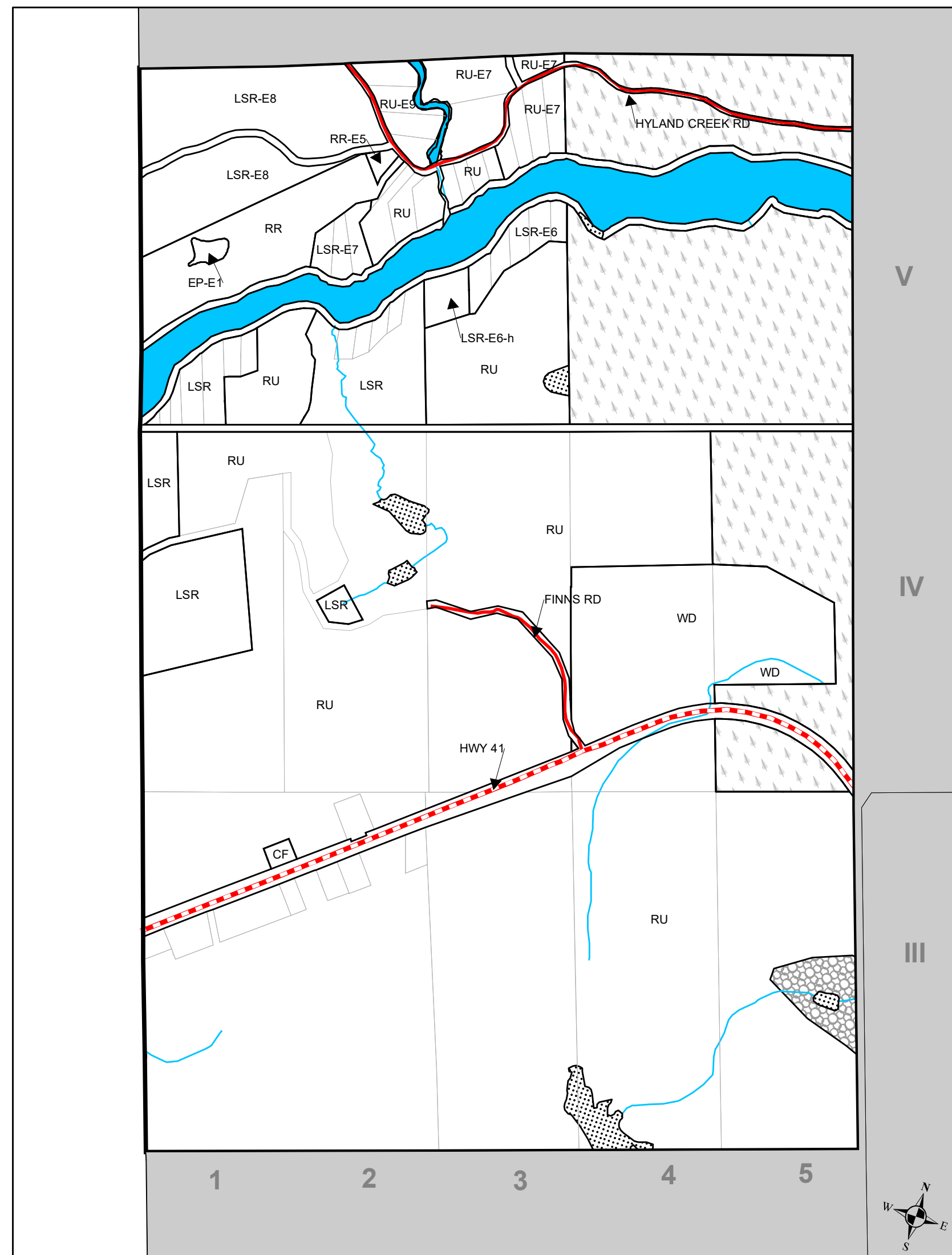

**Inset # 9**

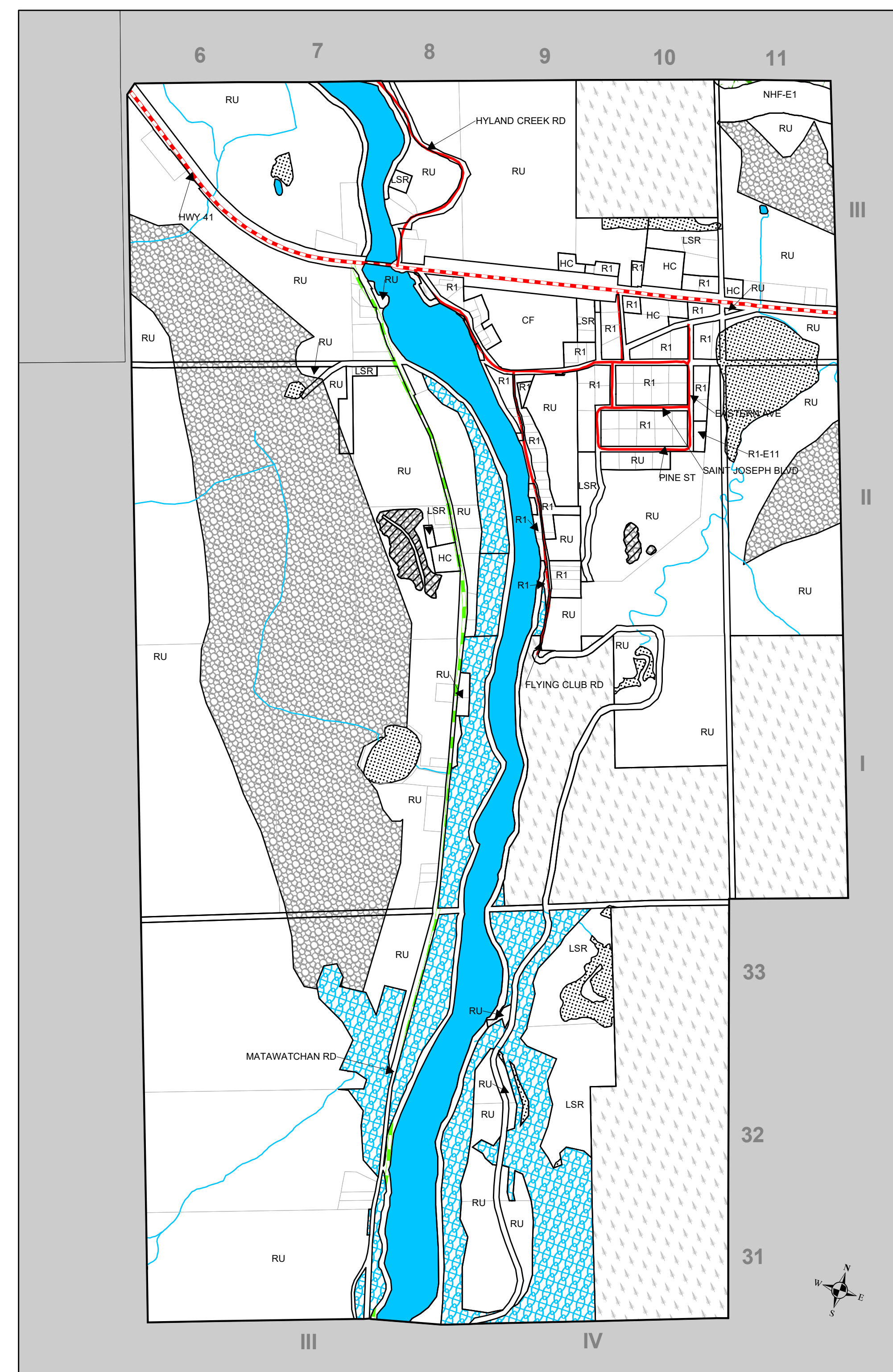

**Inset # 6**

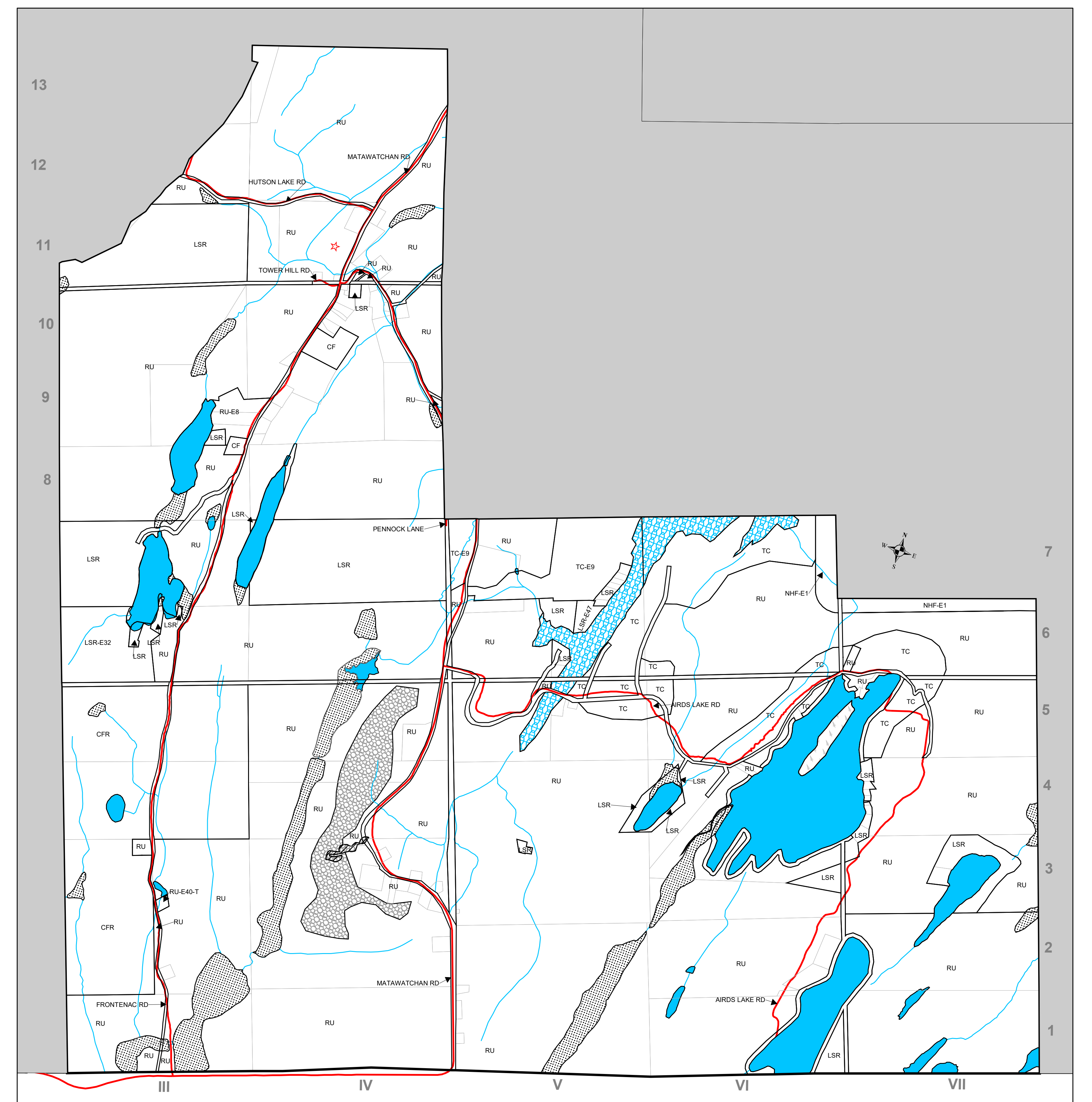

This is Schedule "E" to By-Law No. 22-2003  
Passed the 25<sup>th</sup> day of November, 2003.

Signatures of the Signing Officers

*John McLeod*     *Cathy Ruddy*  
Reeve                     Clerk

**Legend**

- |  |                                     |
|--|-------------------------------------|
| <b>R1</b> Residential One  | <b>CFR</b> County Forest            |
| <b>RR</b> Rural Residential  | Crown                               |
| <b>LSR</b> Limited Service Residential   | Flooded Area                        |
| <b>MHP</b> Mobile Home Park  | Environmental Protection (EP)       |
| <b>HAC</b> Hamlet Commercial   | Extractive Industrial (EM)          |
| <b>HC</b> Highway Commercial   | Extractive Industrial Reserve (EMR) |
| <b>TC</b> Tourism Commercial   | Natural Heritage Feature (NHF)      |
| <b>GM</b> General Industrial   | Open Water                          |
| <b>DM</b> Disposal Industrial  | Sensitive Lake                      |
| <b>MM</b> Mining Industrial  | Inactive Waste Disposal Site        |
| <b>MMR</b> Mining Industrial Reserve   | Water Course                        |
| <b>LM</b> Light Industrial   | K & P Corridor                      |
| <b>RU</b> Rural  | County Road                         |
| <b>CF</b> Community Facility   | Provincial Road                     |
| <b>OS</b> Open Space   | Municipal Road                      |
| <b>-E1</b> Exception One ( Numbered consecutively for each respective zone classification e.g. RU-E1, RU-E2, etc.) |                                     |

**Inset # 8**

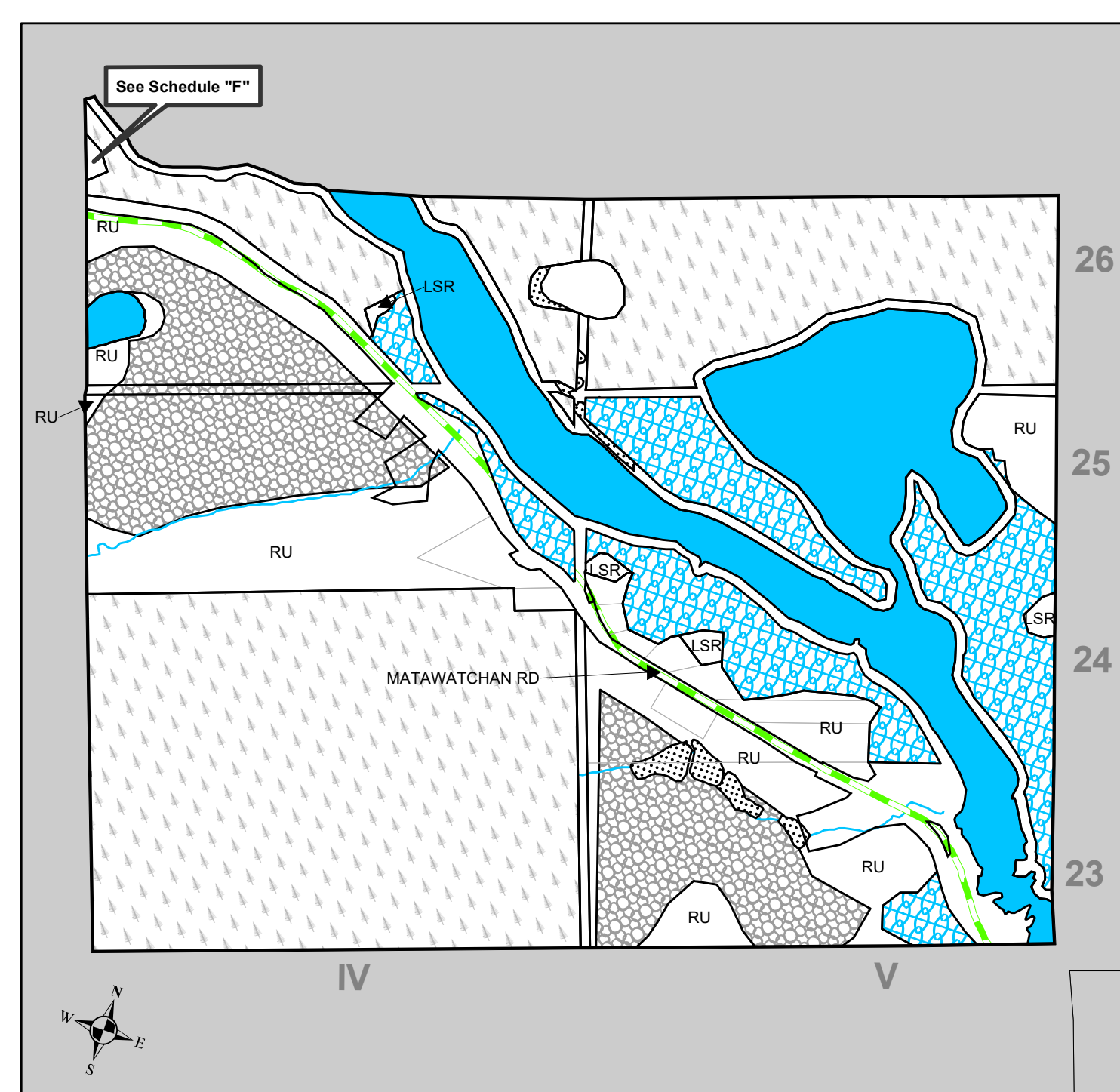

**Inset # 7**

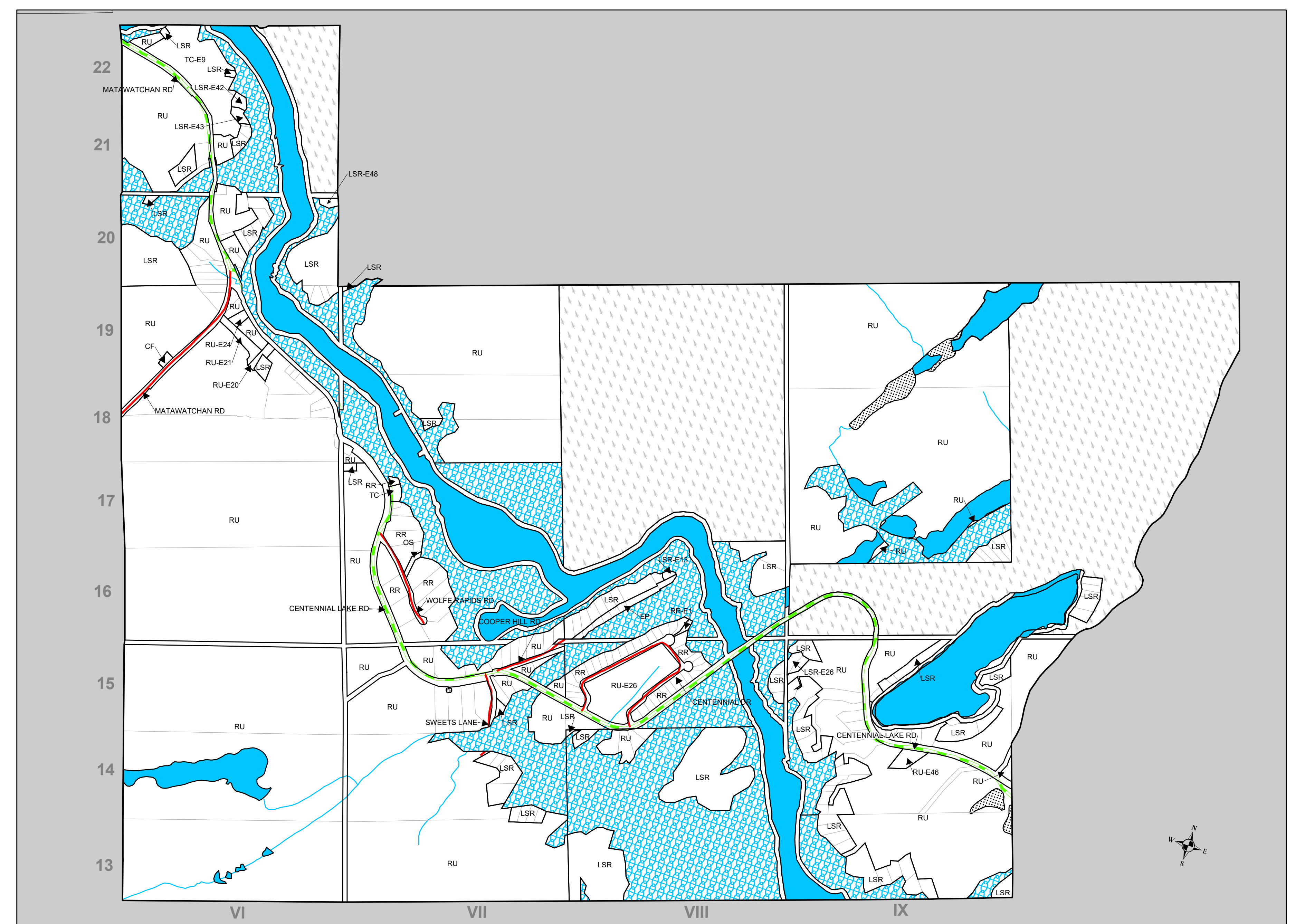

Last Consolidated  
June 21, 2021

**1:12,000**

